

ROOT BARRI-

EP Series Root Barrier Panels

Made from injection molded High Impact Polypropylene (HIPP) with a unique factory installed joiner strip that eases installation. EP Series Panels include a "T" top edge to prevent root overgrowth and an Anchor Lock™ external flange at the base to lock panels in the ground. Suitable for all planting installations. Available in 12", 18", 24", and 36" depths.

Specifications:

EP Series Panels have a minimum thickness of 0.090 inches, and are made of 50% post consumer High Impact Polypropylene with built in U.V. inhibitors to ensure longevity. The EP Root Barrier Panels have 1/2" raised vertical ribs running perpendicular to the panel and 6" on center. All EP Series Panels feature a 3/8" wide "T" top edge and an external ground anchor base flange that is 1/8" wide.

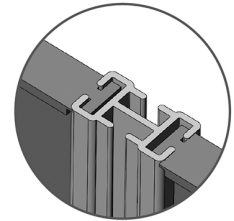
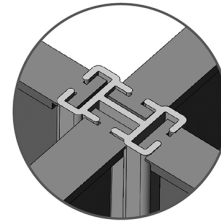

Quad Clip™ Joiner Strips

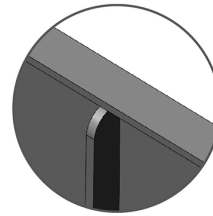

Reinforcing Ribs

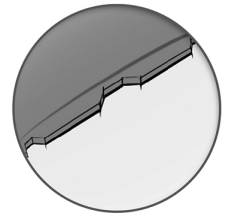

Anchor Lock™

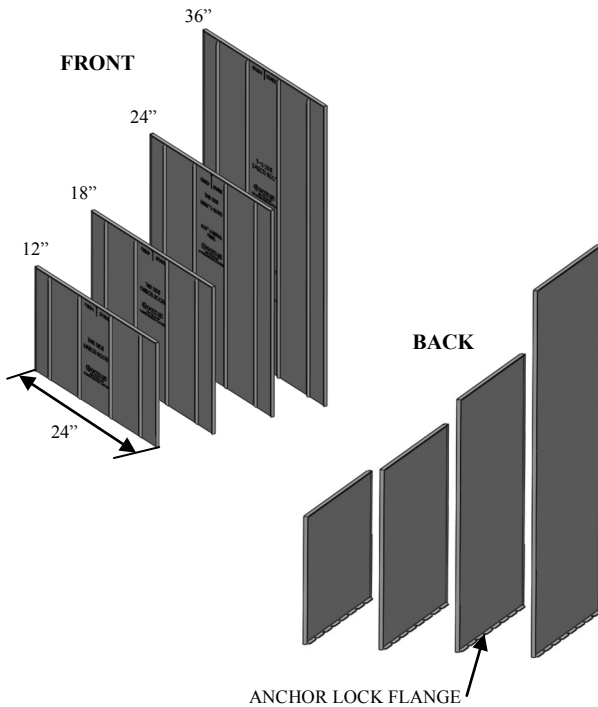

PART NUMBER	DESCRIPTION	COLOR	PACKAGE QTY.	WT. EA (LBS)	PRODUCT CLASS
EP-1250	12" X 24" ROOT BARRIER PANEL	BLACK	25	1.56	50LP
EP-1850	18" X 24" ROOT BARRIER PANEL	BLACK	25	1.80	50LP
EP-2450	24" X 24" ROOT BARRIER PANEL	BLACK	25	2.12	50LP
EP-3650	36" X 24" ROOT BARRIER PANEL	BLACK	25	3.20	50LP

ASTM SPECIFICATIONS EP SERIES ROOT BARRIER PANELS

PROPERTIES	TENSILE STRENGTH	YIELD ELONGATION	FLEXURAL MODULUS	NOTCHED IZOD IMPACT	ROCKWELL HARDNESS
ASTM TEST (UNITS)	D638 (PSI)	D638	D790A (PSI)	D256 (PSI)	D785
VALUES	3,600-4,200	12%	150,00	3.0 @ 73°F	R70

RECOMMENDED INSTALLATION

SURROUND APPLICATION	PANELS PLACED AROUND ROOT BALL, AT SUFFICIENT DISTANCE TO ALLOW PROPER BACKFILL OF MATERIALS.
LINEAR / ROOT PRUNING APPLICATION	PANELS PLACED DIRECTLY ADJACENT TO THE HARDSCAPE BEING PROTECTED.