

Low Profile Underground Tank Installation Instructions

For septic installations, it is important to contact your local or state sanitarian regarding approved installation procedures. Refer to **SITE SELECTION/PREPARATION** located on the Snyder or Norwesco website.

• Water runoff caused by sloping terrain, adjacent structures, or paved surfaces can be problematic if the site selection and installation are not managed properly. Refer to **SITE SELECTION/PREPARATION** located on our website on the proper methods of managing these issues. Failure to locate the tank site properly in areas of water runoff caused by sloping terrain, adjacent structures or paved surfaces, and/or not managing the installation properly can void the warranty.

1. EXCAVATION

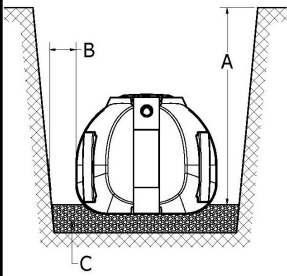

- A.** Excavate to a depth that will provide a minimum of 6" and maximum of 36" of cover over the top of the tank.
- B.** Allow 18" to 24" on both sides and both ends of the tank.
- C.** Prepare the tank bed. Preferred bedding material is well-packed sand — 6" minimum in soil terrain, 12" minimum in rock terrain. Native soil can be used if it is flowable, compactable, rock free, and can provide uniform support in the recessed rib areas. The tank should be installed level. Level tolerance is +/- 1/2" from each end.

2. BACKFILL MATERIALS

- A.** Free flowing native soil can be used as backfill. All fill must be free of any wood, masonry debris, or silt. Shrink/swell clay soils should be avoided as backfill material.
- B.** If the native soil is unsuitable, replace it with a free flowing, compactable material. A typical specification is 100% smaller than 1 1/2" and approximately 50% smaller than 1/4".
- C.** Sharp objects must not come into contact with the tank.

3. BACKFILLING EXTERIOR

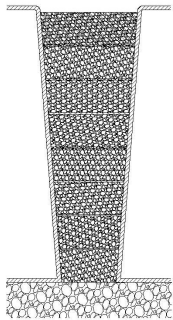

- A.** Backfill around tank with 12" layers and compact each layer. Always compact ends first.
- B.** Each of the interior support columns must be filled with free-flowing fill and compacted in 6" layers. The columns must have the soil compacted to provide structural support. See diagram.
- C.** Be sure to compact soil under inlet and outlet piping.
- D.** Maximum backfill over the top of the tank is 36".
- E.** Mound soil over the top of the tank to direct surface water away from the tank.

4. SEPTIC TANK CONNECTIONS

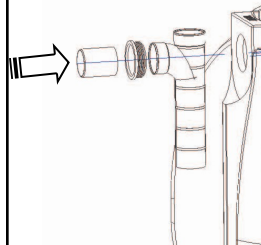

- A.** Low Profile septic tanks are provided with 4" PVC sanitary tees and rubber gaskets for the inlet and outlet.
- B.** All pipes should be chamfered and gaskets lubricated.
- C.** Install gasket from the outside of the tank as shown in the diagram. From outside of the tank, push the pipe into the gasket.
- D.** Inlet and outlet piping should be solvent welded to sanitary tees.
- E.** Note the direction of flow. The outlet is lower than inlet and all tanks are marked accordingly.

5. MANHOLE EXTENSIONS

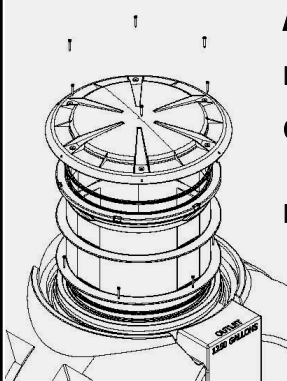

- A.** Install manhole extensions and/or lid risers **before** you backfill.
- B.** Manhole extensions are supplied with gaskets and screws.
- C.** Install screws as shown in the diagram around the circumference of the base of the extension.
- D.** Be sure that the self-tapping screws seat squarely into the tank. Do not over-tighten screws.

6. CISTERN / PUMP TANK INSTRUCTIONS

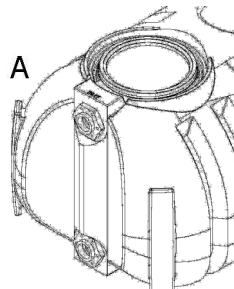

- A.** Install bulkhead fittings at the flat areas located on either end of the tank.
- B.** All tanks must be vented including each tank in an interconnected series.
- C.** The vent pipe should be the same diameter as the outlet pipe.
- D.** When multiple tanks are installed in series, you must maintain at least 36" of separation between tanks.
- E.** Flexible connections are required between each tank on interconnected tank installations.

CAUTION

Failure to comply with the points below voids warranty.

- A. Tanks are not fire-resistant. Do not store them near an open flame or heat in excess of 180 °F.
- B. Do not install any tank under the path of vehicles or heavy equipment.
- C. Do not leave Low Profile septic tanks empty for extended periods of time.
- D. Low Profile septic tanks and cisterns are designed only for use as underground tanks.
- E. Low Profile septic tanks and Low Profile cisterns may be used as holding tanks or for pumping applications where permitted by local codes.
- F. Low Profile natural colored cisterns are made of resins that meet FDA specifications for the storage of drinking water and can be used for that application.
- G. Protect the tank from sharp objects which could puncture it and cause leakage.
- H. Where saturated soil or seasonal high water tables are indicated between the bottom of the tank and the ground surface, see separate Supplemental Installation Instructions on our website.
- I. For installations requiring counter-buoyancy measures; please refer to Counter-Buoyancy Instructions on our website.
- J. Maximum temperature of liquid entering tank is 120° F.
- K. Maximum bulkhead fitting size is 4”.

It is not advised to use this plastic underground tank for any application other than typical household sewage. Such uses would void product warranty.

WARRANTY

Manufacturer warrants that if this part is proven to be defective in material or workmanship within five (5) years from the date of manufacture, manufacturer will (at company's option) either replace or repair said part. This standard limited warranty does not apply to damages resulting from misuse, improper application of recommended materials, accident, or improper installation or maintenance. Remedy to the buyer is limited to the replacement of any defective product (or its component where applicable), F.O.B. point of manufacture. The buyer's remedy under this warranty does not include any other direct or indirect consequential damages which result from defects in material and/or workmanship of its products.



**DRAINAGE
SOLUTIONS, INC**



(317) 346-4110

www.drainagesolutionsinc.com